

Nox Tunable White 12W Data Sheet

Nox Tunable White, 12W/m, 2100K - 6500K, CRI 90

*Features

- Tunable white 2100-6500K, high CRI 90, CCT+RGB optional
- 12W/m, high brightness max 1200lm/m@4000K for general lighting
- Max Light efficiency 100lm/W@4000K
- CCT & colors controlled by DALI / Casambi wire or wireless
- 24V, high power efficiency
- Wide beam angle 130°
- Applied in office, hotel, villa, shop and home
- 3M adhesive back tape
- Good dissipation, 25000hrs lifespan, 40000hrs long lifespan with heatsink



Technical data

Electrical specifications						
Wattage (W/m)	12	AC input voltage (V)	-			
DC input voltage (V)	24	Power factor	-			
Frequency (Hz)	-	Total harmonic distortion (THD)	-			
Dimming type	SW&Sig mesh/ SW&Zigbee/ SW&Triac dim/ SW&switch	Flicker-free	-			
Max. no. of lamps on B16A circuit breaker	-	Max. no. of lamps on C10A circuit breaker	-			
Max. no. of lamps on C16A circuit breaker	-					
Photometric specifications						
Part No.	CCT	CRI	Lumen/M	Luminous Efficiency (lm/W)	Beam angle	Standard deviation of colour
CVAFEC112C08D10-75742	2100K	90	780lm± 5%	65lm/ W	130°	5 SDCM
	2700K		900lm± 5%	80lm/ W		
	3000K		1000lm± 5%	90lm/ W		
	4000K		1200lm± 5%	100lm/ W		
	5000K		1150lm± 5%	95lm/ W		
	6000K		1000lm± 5%	90lm/ W		
Mechanical specifications						
Housing material		Housing Colour				
Optical cover/ lens material	-	Length/ diameter (mm)		10000		
Width/ diameter (mm)	8	Height (mm)		1.8		
Cut length (mm)	62.5	Product weight				
Lifespan						
Number of switching cycles	100000	L70/B50 service life at 25°C	40,000 hrs			
L80/B10 service life at 25°C	25,000 hrs	L90/B10 service life at 25°C	20,000 hrs			
Warranty period	5 Years					

Application parameters			
Working temperature range	-20~+60°C	Storage temperature range	-20~+70°C
Additional product specifications			
Type of installation	3M adhesive tape	Location of installation	-
Connection type	Connector	Protection type	IP20

- Power off before replacement
- Do not be in violation of any fire regulations when using
- Consult qualified electricians for technical support
- If the supply cord is damaged, it shall be exclusively replaced by the manufacturer or his service agent or similar qualified person in order to avoid a hazard

Dimensions

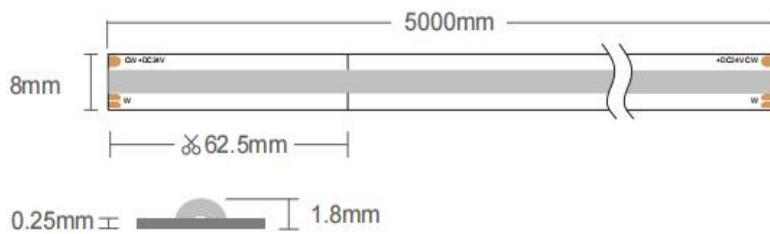

*Product & Wiring Connection & Cautions

Product connections



Insert each ends of led strips into the end of the connection terminal respectively, make sure the metal clip is on the same side as the metal solder pad of led strip.



After complete the insert, also make sure both ends of led strip are tightly connected.



Press the metal clip down with the appropriate plier to ensure that the metal clip is inserted into the appropriate position ,and connection completed.

Wiring connections

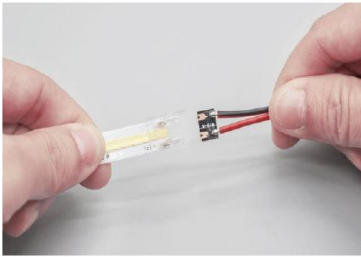

Insert one end of led strip and wire connector into both ends of the connection terminal respectively to ensure that the metal clip is on the same side as the metal solder pad of led strip.

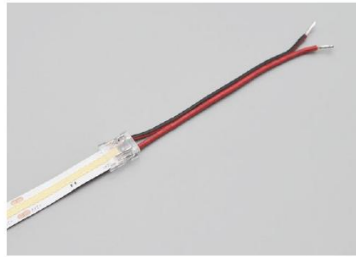

Meanwhile make sure both ends are closely connected, Press the metal clip down with the appropriate plier to ensure that the metal clip is inserted into the appropriate position ,and connection completed.

Cautions

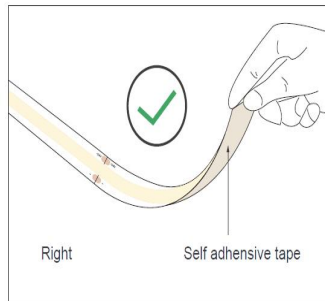
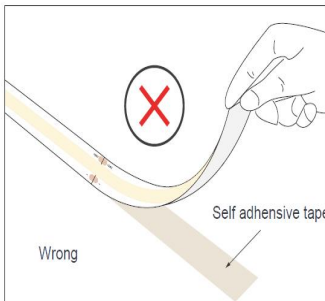

If the led strip needs to be torn up, please make sure that the self adhesive tape is torn with the led strip, otherwise the led strip will be damaged.

When install the led strip,please note the installation technique
The led strip can be bent, but not distorted,as shown below

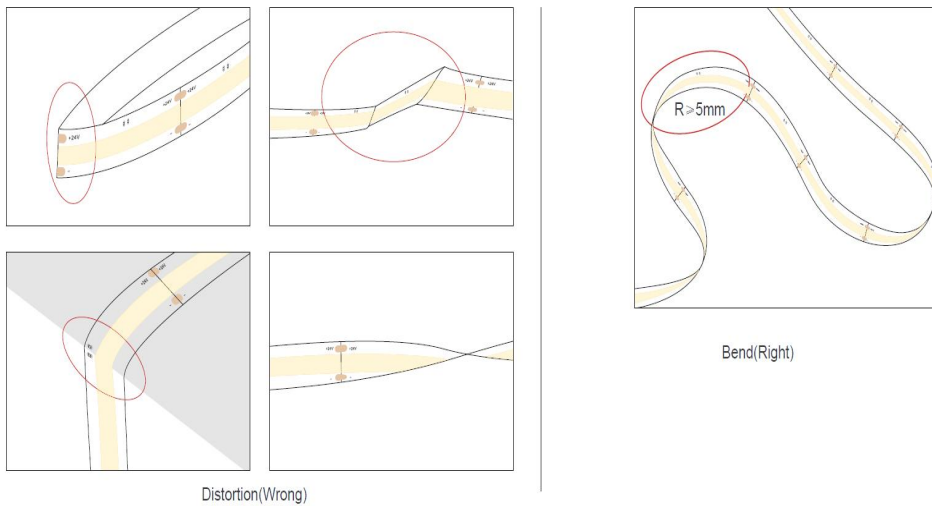

LED strips are low voltage products, you must use the power supply(transformer). Please don't connect the led strip directly to the AC 110v or AC 220v, otherwise it will burn out the LED strips.

Clean up the installation surface and it will ensure the reliability of the adhesive. The electrical connection process must be operated by a professional person.

Wiring Diagram



*Installation Step

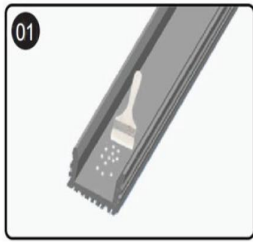

1.Clean

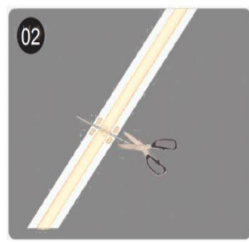

2.Cut

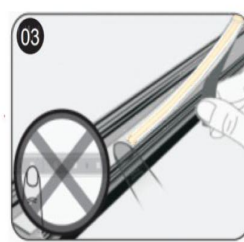

3. Peel off the paper

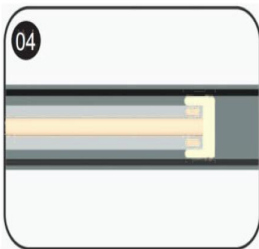

4.Stick the strip



5.Vertical Installation

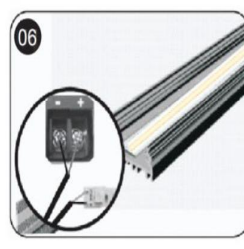

6.Connect the power
& IP65 attention

*Accessories / Parts (Optional):



*Semi-transparent
Plastic Cover



*Connector Clamp



*Aluminum slot Clamp



*Aluminum slot

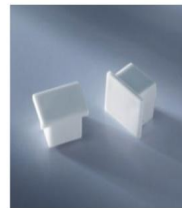

*Square plastic Cover